

LED DRIVERS - CONSTANT CURRENT LDC-300 SERIES

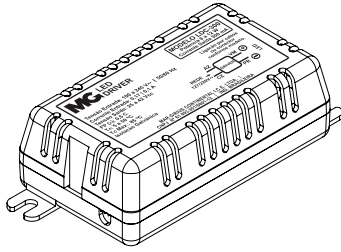

For led ceiling lights
 High efficiency
 Long life: 50000h with $T_c = 70^\circ\text{C}$
 Short circuit, overload and open circuit protections
 Manufactured with high quality electronic components



LDC-300 SERIES

- Supply voltage: 100-240V~ 50/60Hz
- Output constant current: 300mA
- Maximum environment temperature (T_A): 5 to 50°C
- Maximum enclosure temperature (T_c): 85°C

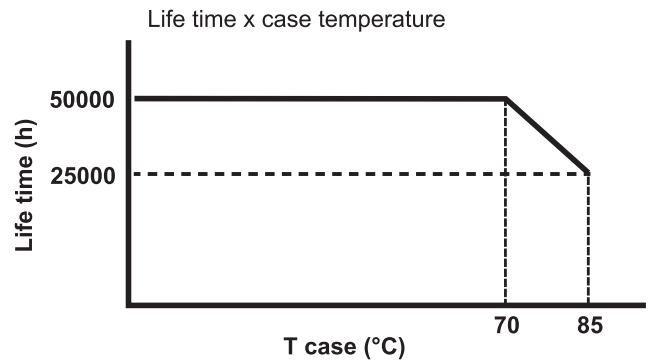

Product	Output power (W)	Output voltage (VDC)	Power factor	Output current (mA)	Maximum input current (A)	Efficiency 127V (%)	Efficiency 220V (%)	THD (%)	Degree of protection	Circuit	Size
LDC-300	6 to 12	18 to 42	0,5	300	0,16 0,10	90	91	155	IP20	Not isolated	1
LDC-300	8 to 25	25 to 84	0,5	300	0,34 0,19	89	90	143	IP20	Not isolated	1
LDC-300	8 to 12	25 to 42	0,5	300	0,17 0,10	90	91	155	IP20	Isolated	2
LDC-300	12 to 25	38 to 84	0,5	300	0,34 0,19	89	90	142	IP20	Isolated	2
LDC-300	24 to 36	75 to 124	0,97	300	0,27 0,17	90	92	18	IP20	Isolated	3

DIMENSIONS

Size 1

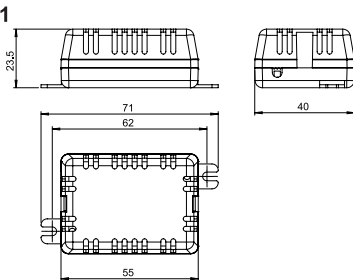

Size 2

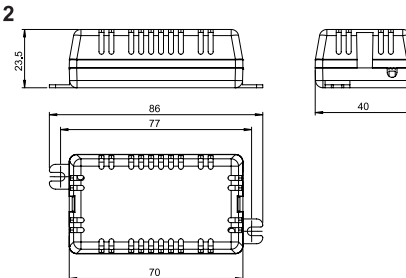

Size 3

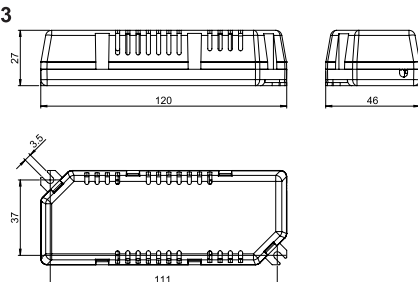

WIRING

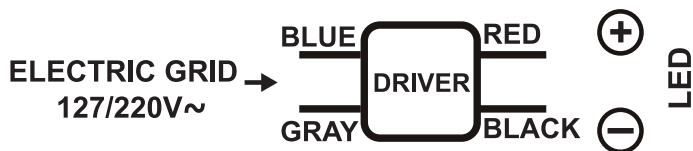

Note: Output with cables or connectors according to model.
Caution: Do not connect the ceiling with the driver energized.

POWER FACTOR BF – Low factor (0,5) AF – High factor (0,97)	VOLTAGE 6 – Autovolt (100 to 240V~)	OUTPUT POWER P1 – 6 to 12W P2 – 8 to 12W P3 – 8 to 25W P4 – 12 to 25W P5 – 24 to 36W	
CIRCUIT I0 – Not isolated I1 – Isolated (galvanic isolation)	DIMERIZATION D0 – Non-dimmable	OUTPUT C1 – Cables C2 – Connector	DEGREE OF PROTECTION G1 – IP20

SELECTION GUIDE

LDC -	□□□	□□	□	□□	□□	□□	□□	□□
	current	power	supply	output power	circuit	dimerization	output	degree of
	300	factor	voltage	P1 - 6 to 12W	I0 - not isolated	D0 - non-dimmable	C1 - cables	protection
		BF	6 - autovolt	P2 - 8 to 12W	I1 - isolated		C2 - connector	G1 - IP20
		AF		P3 - 8 to 25W				
				P4 - 12 to 25W				
				P5 - 24 to 36W				