

# EASY REMOTE CONTROL SET PTRX-141

Easy and practical residential/commercial automation system that allows the activation of floor and desk lamps, fans and other electro-electronic equipment by remote control.



SPECIFICATIONS	
Supply Voltage	Automatic bivolt (100 a 240V~)
Maximum power per channel	500W (resistive load)*
Operation frequency	433,92 MHz
Encoding type	Code Learning
Reach	20 meters without obstacles
Maximum ambient temperature	50°C

\*For lamps, use the table below:

Type of lamp <sup>1</sup>	Voltage	
	127V~	220V~
Incandescent / Halogen	500W	700W
Fluorescent / Compact	125W	250W
LED <sup>2</sup>	125W	125W

1- To drive metal halide, sodium, mercury or mixed light lamps, use auxiliary devices such as contactors.  
2- Do not install more than 7 lamps or light fixtures in the same sensor.

## INSTALLATION AND PROGRAMMING

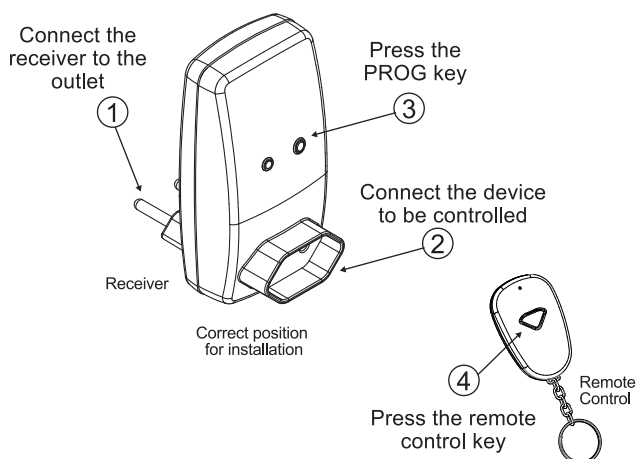

**Caution**  
The equipment connected to the receiver must have the compatible with the local power supply voltage.

## SELECT GUIDE

REMOTE CONTROL SET ( \* )    □□□□ - □□□□    □□+□

Model

PTRX-141 2P

PTRX-141 2P+T

## DIMENSIONS

### PTRX-141 2P

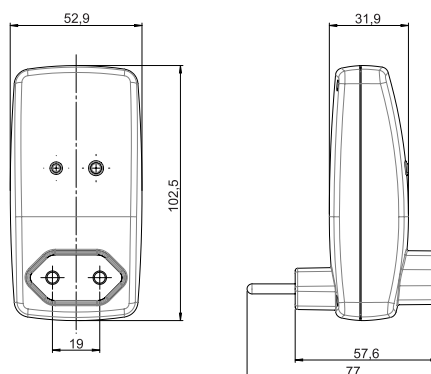

### PTRX-141 2P+T

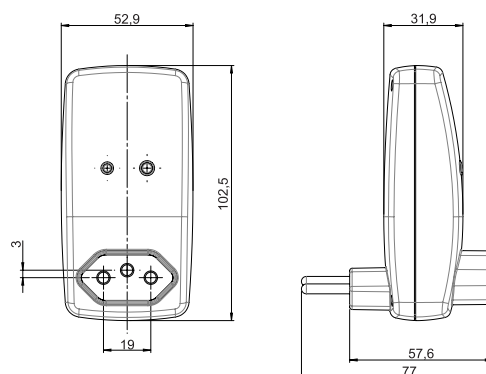

## GENERAL FEATURES

- Models for 2P or 2P+T equipments
- Operation modes of receptor: with retention (bistable) or without retention (monostable)
- Programming up to 40 controls per receiver
- Internal power supply
- Additional remote controls sold separately
- Automatic bivolt - makes installation easier

\* The PTRX-141 Remote Control Set comes with a remote control of 1 key.