

# OUTLETS FOR APPLIANCES

## SPECIFICATIONS:

**ELECTRICAL CHARACTERISTICS:** 10A or 20A in tensions until 250VAC.

**MODELS WITH EXTERNAL AND INTERNAL PIT. THEY ARE IN ACCORDANCE WITH BRAZILIAN STANDARD OF PLUGS AND OUTLETS (NBR 14136).**

**switches for appliances**

Safety



Reference	Number of Conductors	Pit
TPA1 - 3	3 (2P+T)	External
TPA2 - 3	3 (2P+T)	Internal

EXTERNAL PIT



INTERNAL PIT

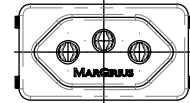

## DIMENSIONS

EXTERNAL PIT

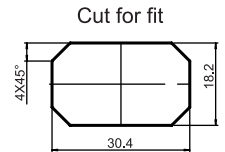
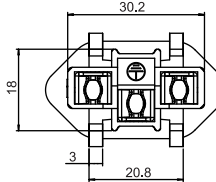
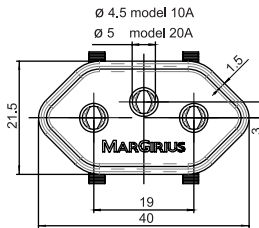
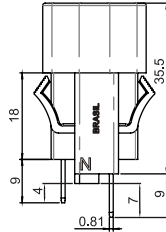
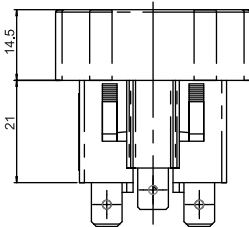

Panel thickness:  
0,8 to 2mm  
2 to 4mm\*  
\*contact us

INTERNAL PIT

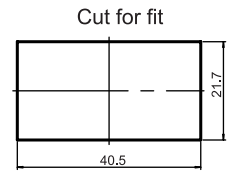
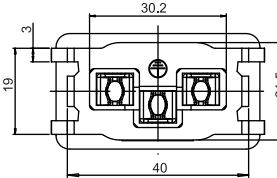
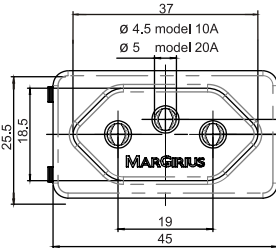
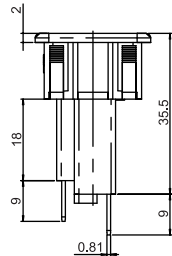
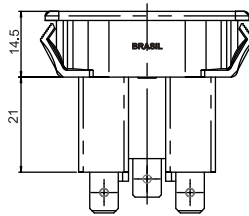

Panel thickness:  
0,8 to 2mm  
2 to 4mm\*  
\*contact us

## TERMINALS

**E1 - Faston**  
2,8 x 0,8mm

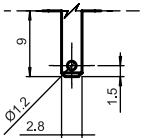

**E2 - Faston**  
4,8 x 0,8mm

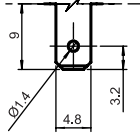

**E3 - Faston**  
6,8 x 0,8mm

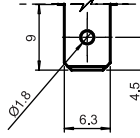

**E4 - Faston with cut**  
6,3 x 0,8mm

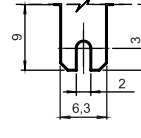

**E5 - Solder**  
2,8 x 0,8mm

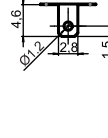

**E6 - Solder**  
6,3 x 0,8mm

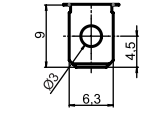

**CI - PC Terminal**

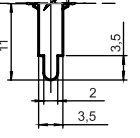

## # - COLORS

A - blue  
AC - cream  
B - white  
C - yellow  
D - green  
E - red  
F - black - (standard)  
G - gray  
H - brown

## CONTACT

10A  
20A

## SELECTION GUIDE

Reference	Terminal	Color	Contact
TPA1 - 3	E1		10A
TPA2 - 3	E2		20A
	E3		
	E4		
	E5		
	E6		
	CI		
	Cable		

Cable - Tail 150mm\*  
3 x 1,5mm<sup>2</sup>

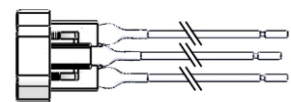

\*Other lenghts contact us